



MOTOSAT 65

MOTOSAT 85

**INSTALLATION GUIDE
AND USER MANUAL**

TELECO

UK

TELECO WARRANTY

Teleco guarantees its satellite dishes and terrestrial antennas against any material and/or construction fault and defect. The warranty offered by TELECO is limited to the free-of-charge replacement or repairing of any parts that are deemed faulty by TELECO. The warranty is applicable for a period of 3 YEARS starting from the product purchase date; however, it will only be considered valid if the Customer is able to produce a written document (invoice or tax receipt) showing the purchase date.

The following is excluded from the TELECO warranty:

- a. Damages caused by incorrect installation and/or use and/or maintenance
- b. Damages resulting from product alterations not authorised by Teleco
- c. Damages resulting from the use of spare parts different from original Teleco parts
- d. Damages resulting from repairs carried out by personnel not authorised by Teleco
- e. Normal part wear;
- f. Expenses incurred for spare parts transport between the Customer's and the service centre
- g. Damages that may occur during transport:
the Customer shall always be responsible for transport risks.

Information

Congratulations on your purchase! MotoSat is among the most technologically advanced products in the field of satellite TV reception. This handbook has been prepared to provide information on how to install, use, maintain and technical specifications your MotoSat.

For additional information, please contact your local dealer or directly the manufacturers:

TELECO s.p.a.

Via E. Majorana 49
48022 LUGO (RA)

Web site: www.telecogroup.com

Technical attendance: 899.899.856

TELECO .p.a. declines all responsibility for any errors contained in this manual. All the contained information are up to the dates of printing and of the above-mentioned software revisions. TELECO .p.a. reserves the right to introduce any modification made necessary by the development of its products.

Installation instructions

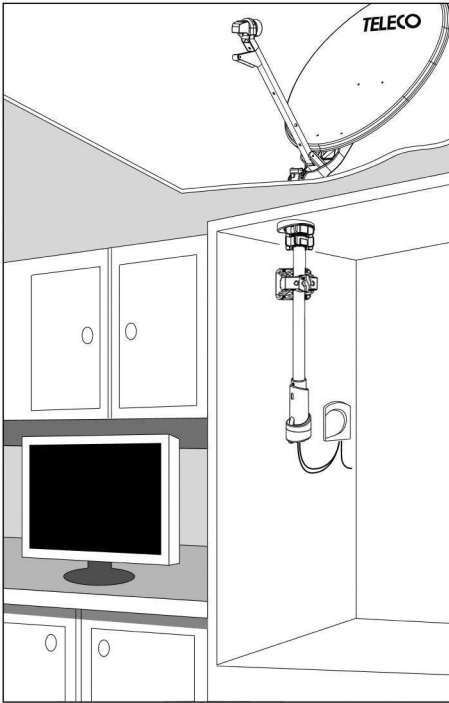

The Motosat antenna must be installed near a vertical wall where the wall outlet can be fitted

Caution:
Mount the antenna away from the vehicle roof edge to avoid overhanging the roof line when travelling.

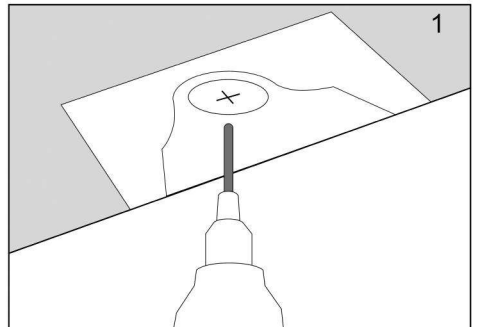
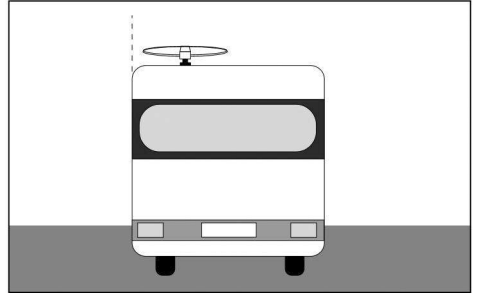

Set the drilling jig in place. Drill in the middle of the jig (page 22)

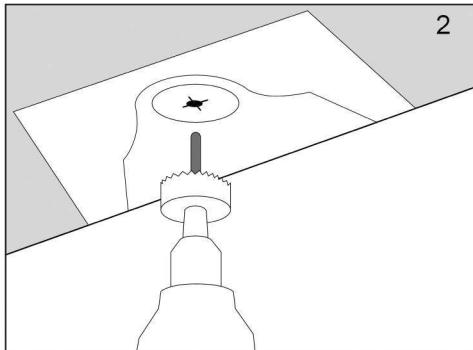

Using a dia. 42 cutter, drill the inside wall first...

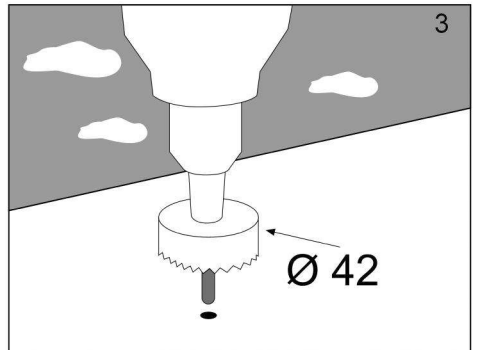

...and then drill the outside wall.

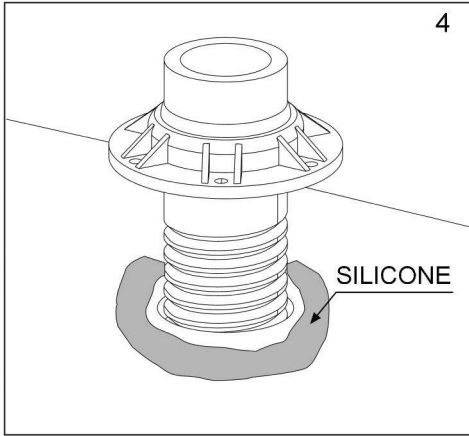

Insert the mast roof mounting bracket in the dia. 42 hole bored in the roof, making sure you apply a layer of silicone under the ring nut.

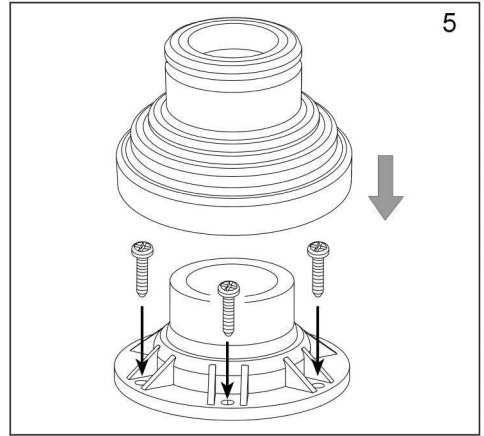

Fasten the ring nut using self-tapping screws. Place the rubber gasket over the ring nut. (Screws not supplied)

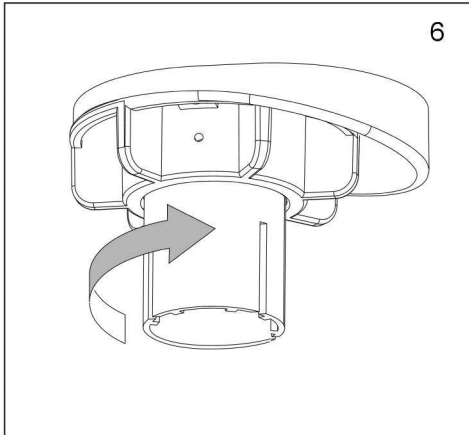

Secure the pipe lead to the roof using the ring nut and its wedge-shaped spacer. **Caution:** the antenna must be in horizontal position. The wedge-shaped spacer is used to set the antenna in the horizontal position even if the roof is inclined.

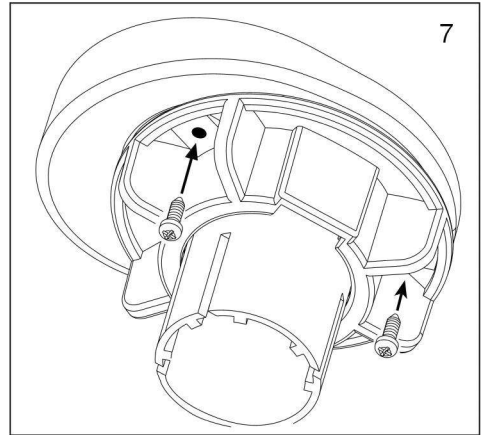

Lock the collar on the wedge spacer by applying the 2 screws (not supplied).

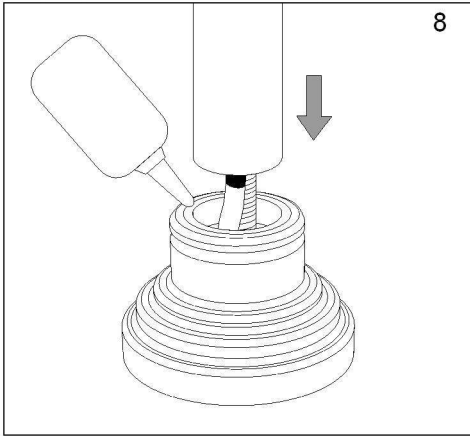

Spread a thin film of Vaseline inside the seal and introduce the mast

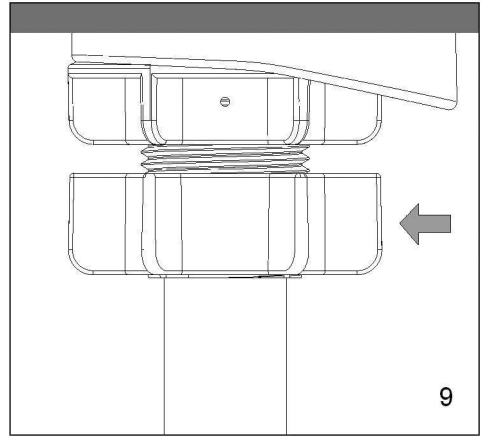

Tight the locking ring nut
This **mast locking** device must be screwed tight every time you wish to secure the antenna in the desired position. To turn or lift the mast, loosen this ring nut.

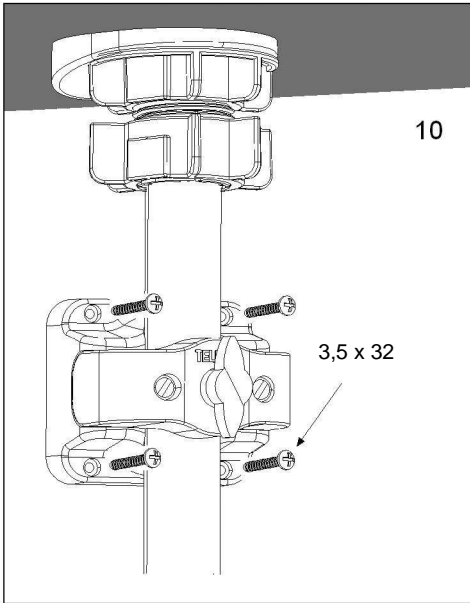

Fix the outlet unit to the wall

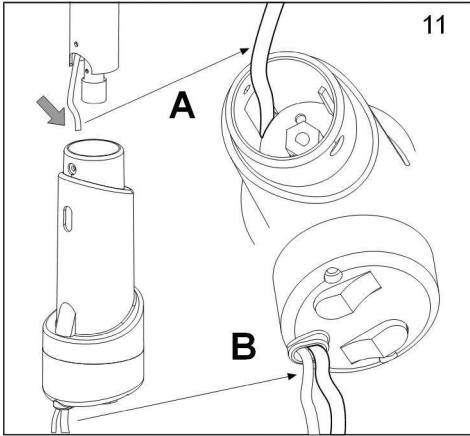

11 Introduce the coaxial cable in the special slot (A) and lead it out of rear bottom side of Motosat (B)

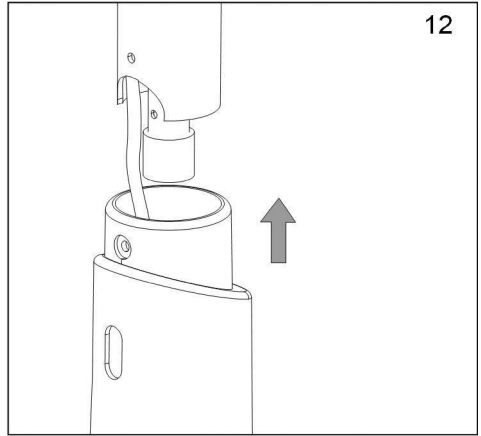

12 Engage Motosat in the antenna support tube until the tube holes are aligned with the Motosat holes.

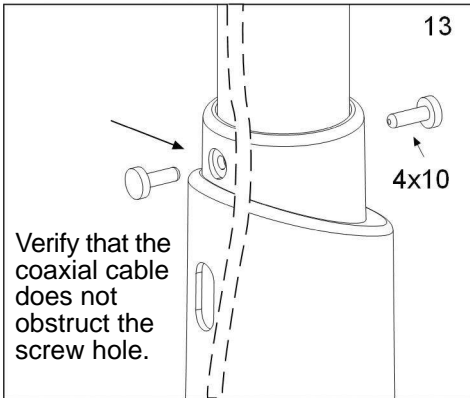

13 Fix Motosat to the antenna support tube with the special screws.

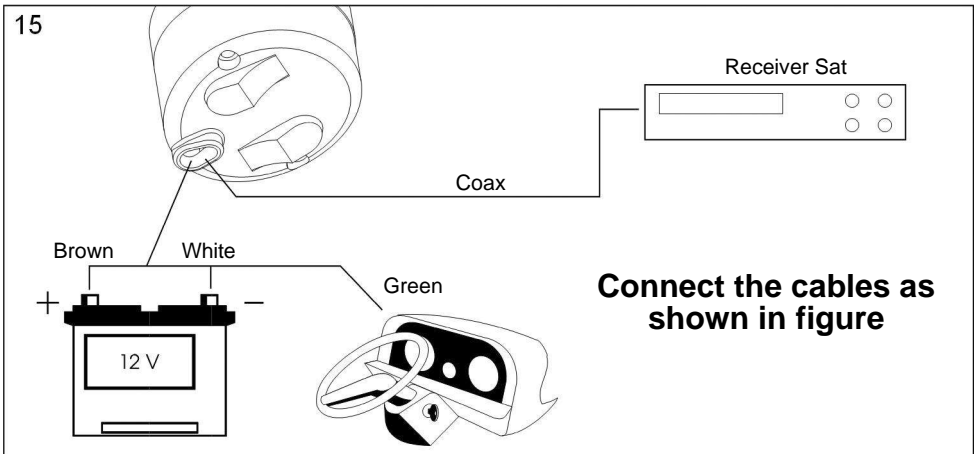
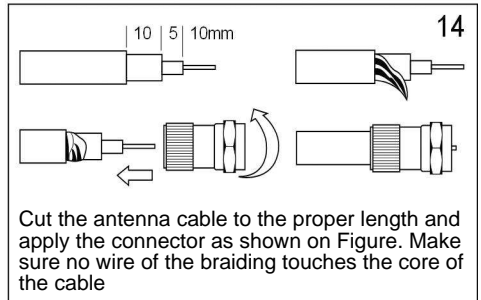

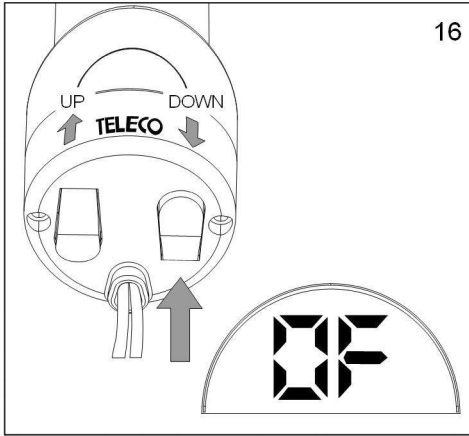

Press the **DOWN** button until the display reads **0F**.

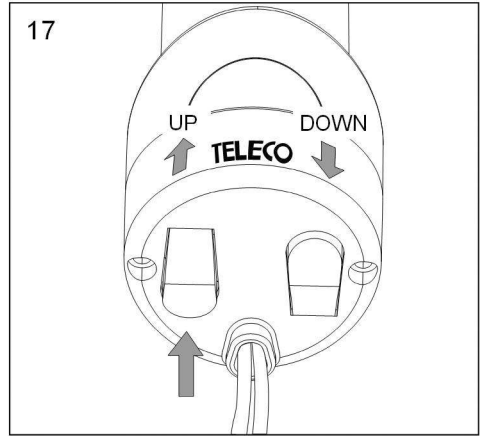

Press the **UP** button until a sequence of beep sounds is obtained.

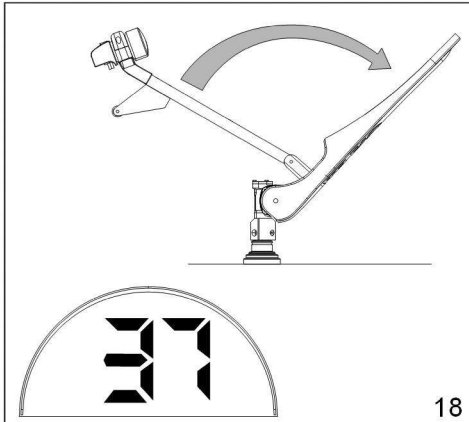

The antenna becomes automatically positioned to facilitate installation (the display reading is 37°).

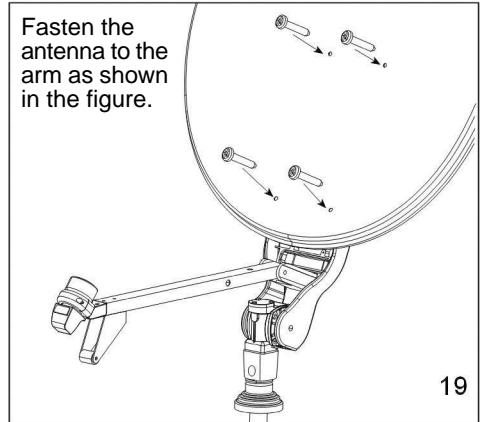

Fasten the antenna to the arm as shown in the figure.

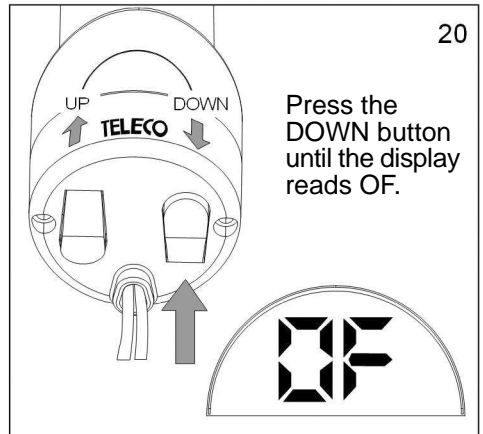

Press the **DOWN** button until the display reads **0F**.

21

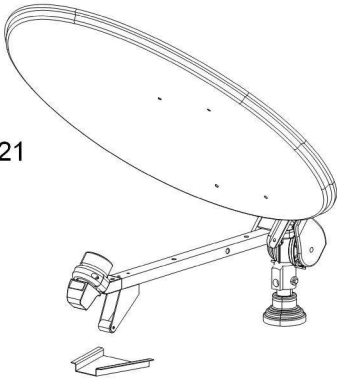

Check that the antenna has been lowered to the required travelling position (fig.22) and glue the steel plate below the LNB shim to the roof with jointing compound or double-sided adhesive tape.

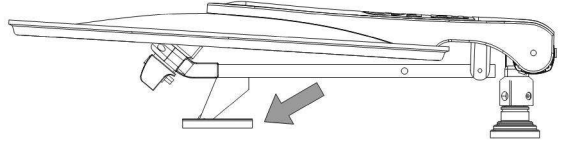

22

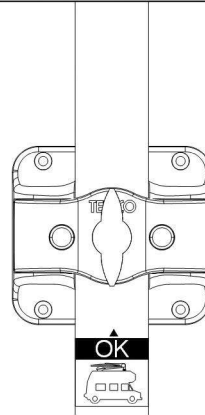
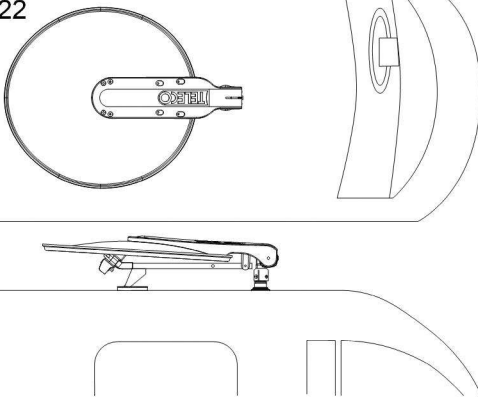

Make sure that the antenna is exactly in its stowed position. Place the sticker on the mast in such a way that you can quickly lock the antenna in the right position before every start.



The antenna must be absolutely installed according to fig. 22, i.e., the disc must be bent to the rear of the vehicle.

Important information for proper antenna tracking

Before performing antenna tracking operation, make sure you have positioned your vehicle so that the view towards the South (where Satellite signals come from) is free from any nearby obstacle (trees, houses, etc.). This way, the antenna will be free to receive signals coming from the satellite.

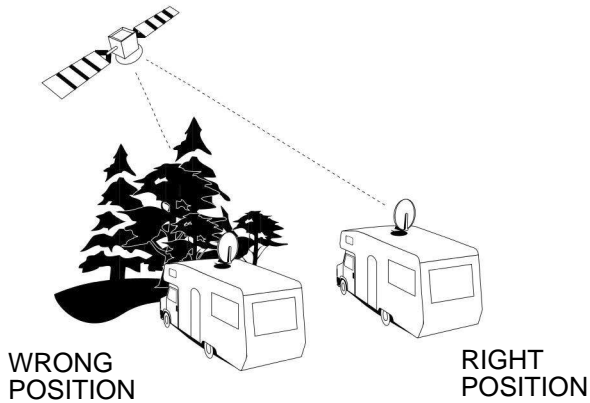

- 1) It is also important to know that satellites do not transmit with the same intensity throughout Europe, so if you are outside the reception area, your Motosat search might be unsuccessful.
- 2) The reception areas for each Satellite can be found on the main magazines dealing in this line of business. Also remember that the larger the dish, the more reception area is available
- 3) Make sure that the vehicle battery is sufficiently charged, if the voltage drops below 11.5 volts the electronic circuit protection prevents MotoSat antenna to move.

OPERATING INSTRUCTIONS

1) Turn on the SAT receiver and TV set following the instructions provided by their respective manufacturers.

2) Hold down the “UP” button until 3 beep sounds are emitted by MotoSat. The antenna will go up to the latest stored position setting
MotoSat will automatically store the latest antenna elevation value to facilitate pointing operations.

3) Slowly turn the mast to the south until TV signals are displayed on the screen.

4) If you haven't been able to find a TV signal, check the elevation reached on the display and compare it with the value shown in table 17. If necessary, use the “UP” and “DOWN” buttons to correct elevation.

NOTE: the elevation reading on the display may be not accurate because of poor levelling of the parked vehicle.

5) Slowly turn the mast to the right/left until TV signals are displayed on the screen.

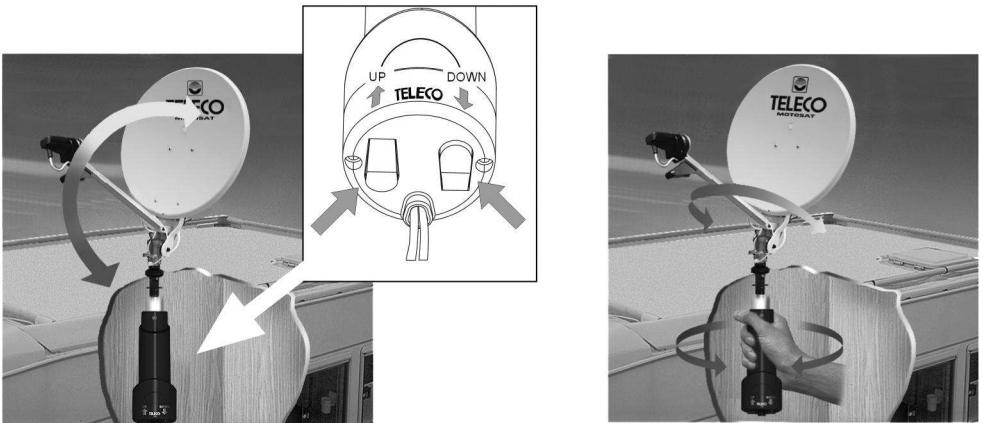

6) To optimise reception, fine-tune both the elevation (with the “UP” and “DOWN” buttons) and azimuth (mast).

ANTENNA FOLDING

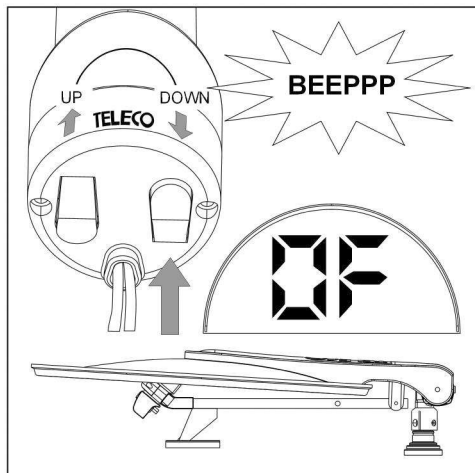

To lower the antenna, hold down the “DOWN” button until the display reads “OF” followed by a prolonged beep sound.

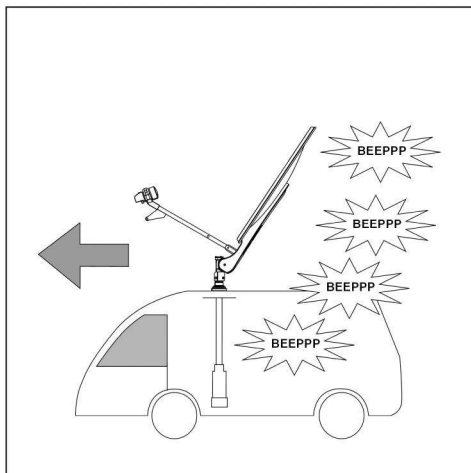

If the green safety cable is connected to the vehicle starter key (fig. 15) and the vehicle is started with the antenna still up, MotoSat will warn the user of the impending danger with a long sequence of beep sounds.

TIPS FOR SUCCESSFUL SATELLITE SEARCHING

If you haven't been able to locate a signal by following the procedure described in points 1-6, we advise to:

- 7) Press the “UP” button to increase the previously set elevation (see point 4) by 2 degrees; then rotate the mast.
- 8) If no signal is displayed on the screen, press the “DOWN” button to decrease the previously set elevation (see point 4) by 2 degrees; then rotate the mast.
- 9) Repeat the above operations alternately, lifting and then lowering the antenna by 4 degrees with respect to the elevation value of point 4 and so on, until a signal is received. Example of a sequence beginning with a 36 degree elevation: 36, 38, 34, 40, 32, 42, 30 etc.

DISPLAY MESSAGES

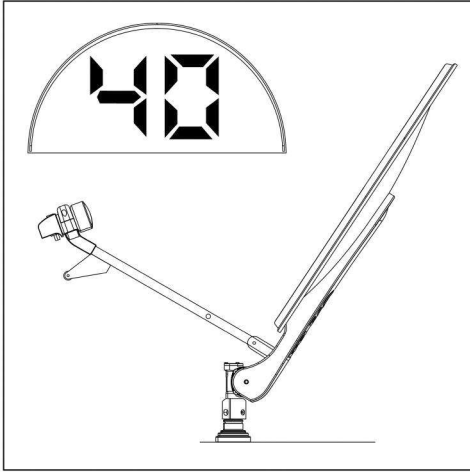

With the antenna up, the display will show the corresponding antenna elevation. The elevation reading may be not accurate because of poor levelling of the parked vehicle.

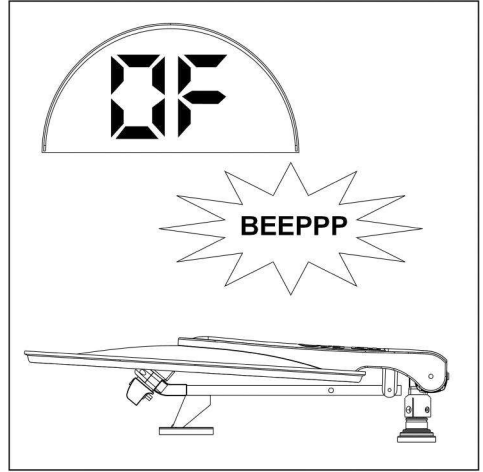

DISPLAY "OF"

The antenna is folded. This message is accompanied by a prolonged beep sound.

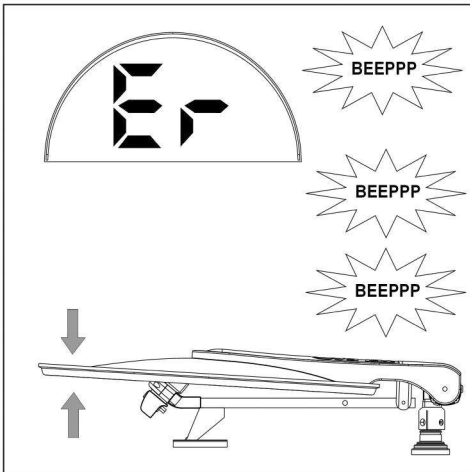

DISPLAY "Er"

The antenna has become locked. This message is accompanied by 3 beep sounds.



Remove any possible obstacle which may block the antenna (such as branches etc.)

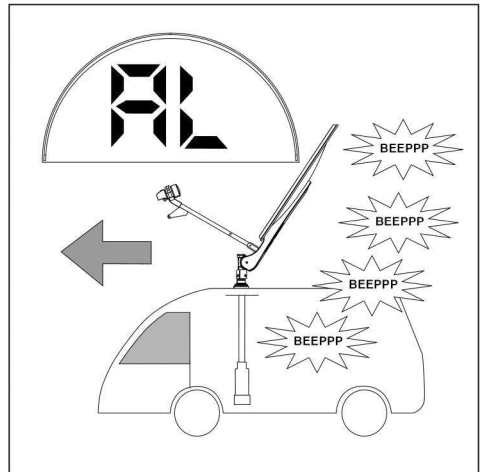

DISPLAY "AL"

The vehicle has been started with an unfolded antenna. This message is accompanied by a long sequence of beep sounds.



Lower the antenna pushing the DOWN button.

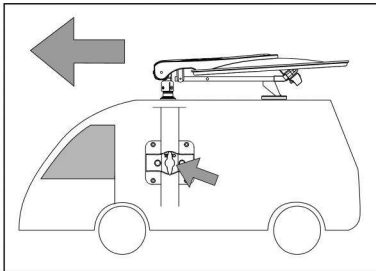

Before starting the vehicle, make sure you have brought down the antenna to its standby position and tightened the knob hard

Failure to comply with these conditions may result in product degradation which the manufacturer cannot be held responsible for.

- 1) It is recommended not to use the antenna under strong wind conditions (80 km/h). Failure to comply with this condition may result in product degradation which the manufacturer cannot be held responsible for.
- 2) The manufacturer declines any liability for all degradations suffered by the product owing to misuse.

LNB rotation for ideal reception in Europe's extreme (South-West or South-East) areas

Remember that the outside converter (a.k.a. LNB) has its own assembly position which must be complied with. Otherwise you will not receive any signal. The pre-set mounting position for the LNB is along the centre line of the disk (fig. A). With this configuration, the Voyager system works correctly in most European countries. However, if you are in areas very far from the satellite orbital position, it might be necessary to adjust the converter angle. In particular, if you wish to receive transmissions from the satellites Astra 19E, Astra 28E or HotBird 13E, while you find yourself in Portugal or Morocco, your converter angle should be adjusted as shown in (fig. B), while if you are in Turkey, to receive the same satellites you should set your converter to the position (fig. C).

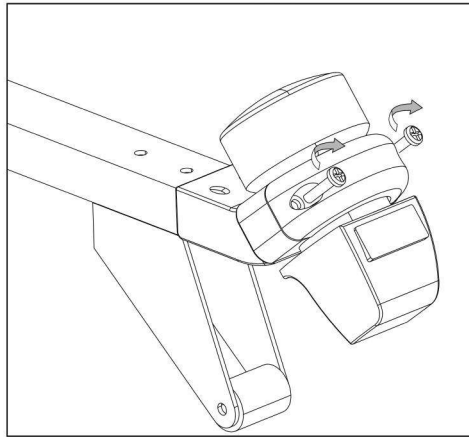
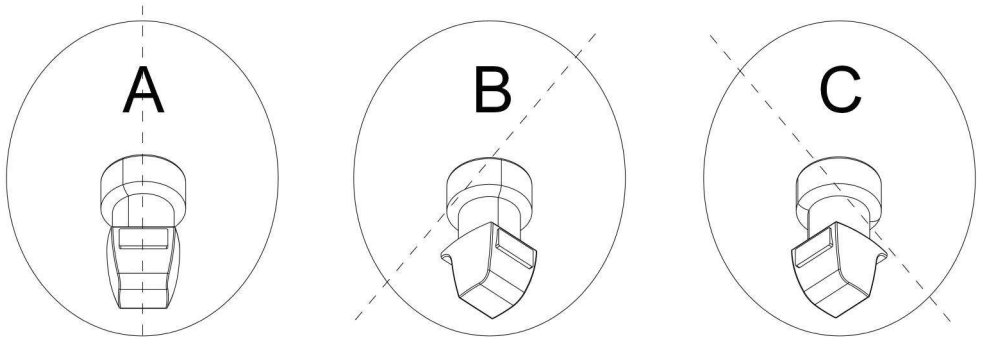

- 1) Loosen the screws on the LNB locking U-bolt
- 2) Turn in the Clockwise (West) or Anti-clockwise (South-East) direction
- 3) Lock the LNB again by screwing down the screw

Place	Position	HotBird 13E	Astra 19E	Astra 28E
Lisbona	B	25°	28°	37°
Casablanca	B	27°	34°	41°
Ankara	C	22°	15°	5°

Dish elevation maps

To correctly point the dish towards your required satellite, it is very important to tilt the dish to the exact angle.

Check your position on the map, then set the dish elevation figure in degrees according to the figure on the required satellite map.

The grey sections in the various maps identify the geographical areas in which LNB adjustment may be necessary.

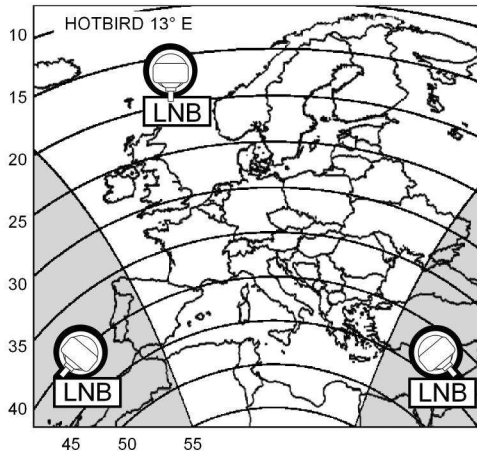
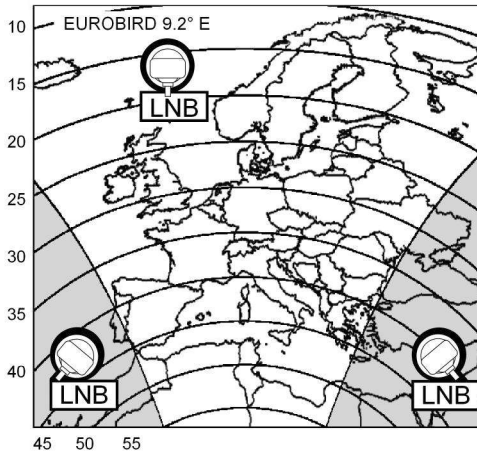

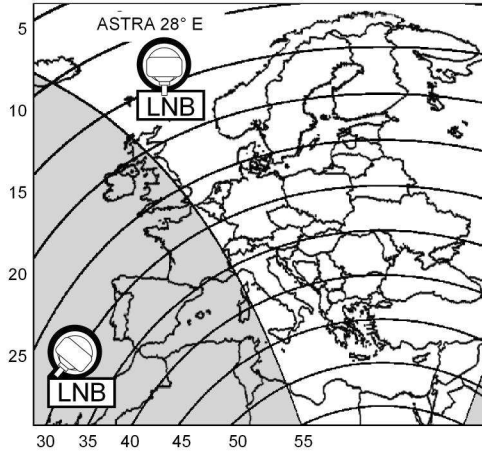
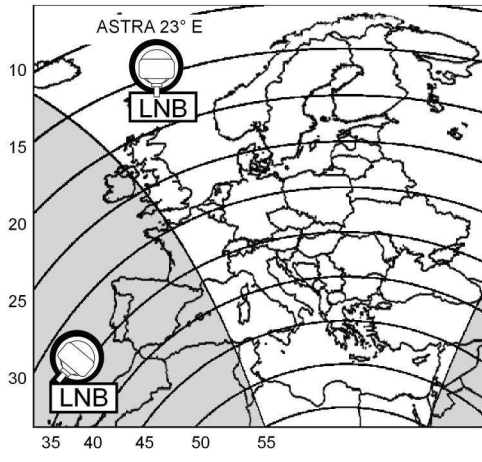
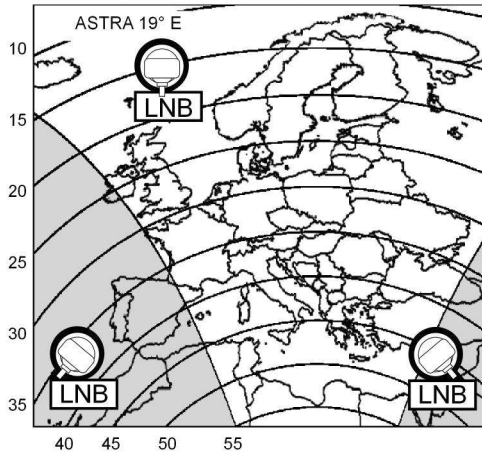

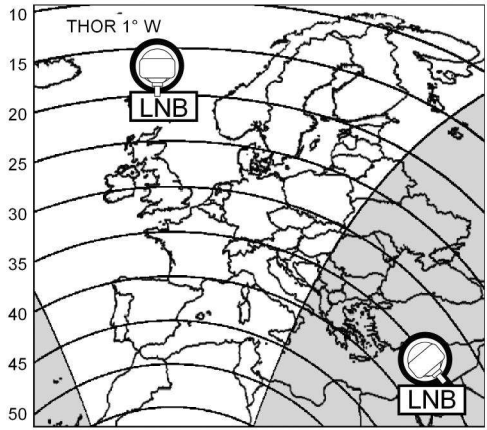

55 .

5

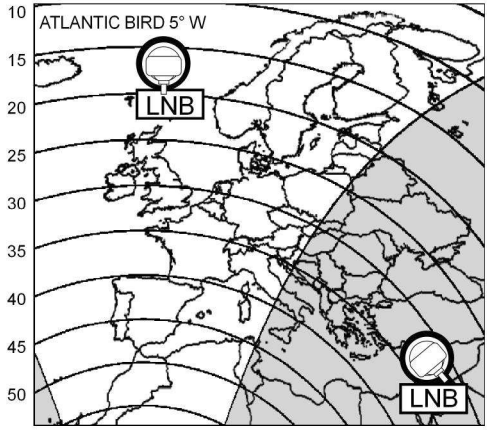

55

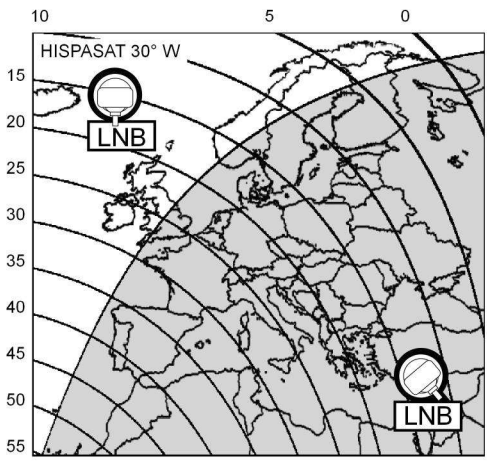

MotoSat elevation to locate satellites in Europe

Country	Town	HOT BIRD 13° EST	ASTRA 19° EST	ATLANTIC BIRD 3 5° WEST	TURKSAT 42° EST	ARABSAT 26° EST
ALBANIA	Tirana	42	42	36	37	42
ALGERIA	Algiers	46	44	47	31	41
	Costantine	47	45	45	34	43
	Oran	46	43	48	29	40
AUSTRIA	Innsbruck	36	35	33	28	34
	Salzburg	35	35	32	28	34
	Vienna	35	35	31	29	34
BALEARICS	Palma	44	42	44	29	39
BELGIUM	Antwerp	31	30	31	22	28
	Brussels	31	30	31	22	28
	Gand	31	30	31	21	28
	Liege	31	30	31	23	29
BULGARIA	Burgas	39	40	31	39	41
	Sofia	40	41	33	37	41
CZECH REPUBLIC	Brno	33	34	30	29	33
	Prague	33	32	30	27	32
DENMARK	Copenhagen	27	27	25	21	26
EGYPT	Alexandria	49	52	38	52	54
	Cairo	50	53	38	53	55
FINLAND	Helsinki	21	22	17	20	22
FRANCE	Lyon	36	35	36	26	33
	Marseille	39	37	38	28	36
	Paris	36	35	36	26	33
	Toulouse	38	37	39	26	34
GERMANY	Berlin	30	30	28	24	29
	Cologne	31	31	31	23	29
	Hamburg	30	28	28	22	27
	Munich	35	34	33	27	33
	Stuttgart	34	34	33	26	32
GIBRALTAR		44	41	48	25	37
GREECE	Athens	45	46	37	42	46
	Iraklion	47	49	38	45	49
	Patras	45	46	38	41	46
	Thessalonica	42	43	35	39	43
HUNGARY	Budapest	35	35	31	31	35
	Pecs	37	37	32	32	36
ICELAND	Reykjavik	12	11	16	2	8
ITALY	Brindisi	43	43	37	37	42
	Cagliari	44	43	42	33	41
	Firenze	39	39	37	31	37
	Milano	37	37	36	28	35
	Napoli	43	43	39	35	41
	Palermo	46	45	42	37	44
	Roma	42	41	38	33	40
	Venezia	38	37	35	30	36
LYBIA	Tripoli	52	51	47	41	49
MAROCCO	Casablanca	45	41	51	24	37
	Fes	46	43	50	27	39
	Marrakech	46	42	53	25	38
	Tangiers	44	41	48	25	37
NETHERLANDS	Amsterdam	30	29	29	21	27
	Eindhoven	31	30	30	22	28
	Rotterdam	30	29	30	21	27
NORWAY	Oslo	22	22	21	17	21
	trondheim	19	19	18	15	18
POLAND	Cracow	32	33	28	29	32
	Gdansk	28	28	24	24	28
	Warsaw	29	30	25	27	30
	Wroclaw	31	32	28	27	31
PORTUGAL	Lisbon	40	36	45	21	32

MotoSat elevation to locate satellites in Europe

Country	Town	HOT BIRD 13° EST	ASTRA 19° EST	ATLANTIC BIRD 3 5° WEST	TURKSAT 42° EST	ARABSAT 26° EST
ROMANIA	Porto	37	35	42	20	31
	Bucarest	37	38	30	36	39
	Timisoara	37	37	31	34	37
RUSSIA	St. Petersburg	20	21	16	21	22
	Moscow	23	25	16	27	26
SLOVAKIA	Bratislava	35	35	31	30	34
	Kosice	33	34	29	31	34
SPAIN	Barcelona	41	39	42	27	36
	Bilbao	40	37	42	24	34
	Carthagene	44	42	46	28	38
	Madrid	40	38	43	24	34
	Seville	42	39	47	24	35
SWEDEN	Goteborg	25	24	23	20	24
	Stockholm	23	23	20	20	23
SWITZERLAND	Berne	36	35	35	26	33
	Geneve	36	35	36	26	33
	Zurich	35	35	34	27	33
TUNISIA	Tunis	47	46	44	35	44
TURKEY	Ankara	39	42	29	43	43
	Istanbul	40	42	31	41	43
	Izmir	44	45	35	43	46
UNITED KINDOM	Belfast	28	27	27	20	25
	Cardiff	31	29	31	21	27
	Dublin	29	28	29	21	27
	Glasgow	26	25	26	18	24
	Inverness	24	23	24	17	22
	Limerick	30	29	29	23	28
	London	30	29	31	19	26
	Manchester	27	26	29	17	24
	Newcastel	26	25	27	17	23
	Plymouth	32	31	32	22	29
	York	27	26	28	17	24

MOTOSAT 65

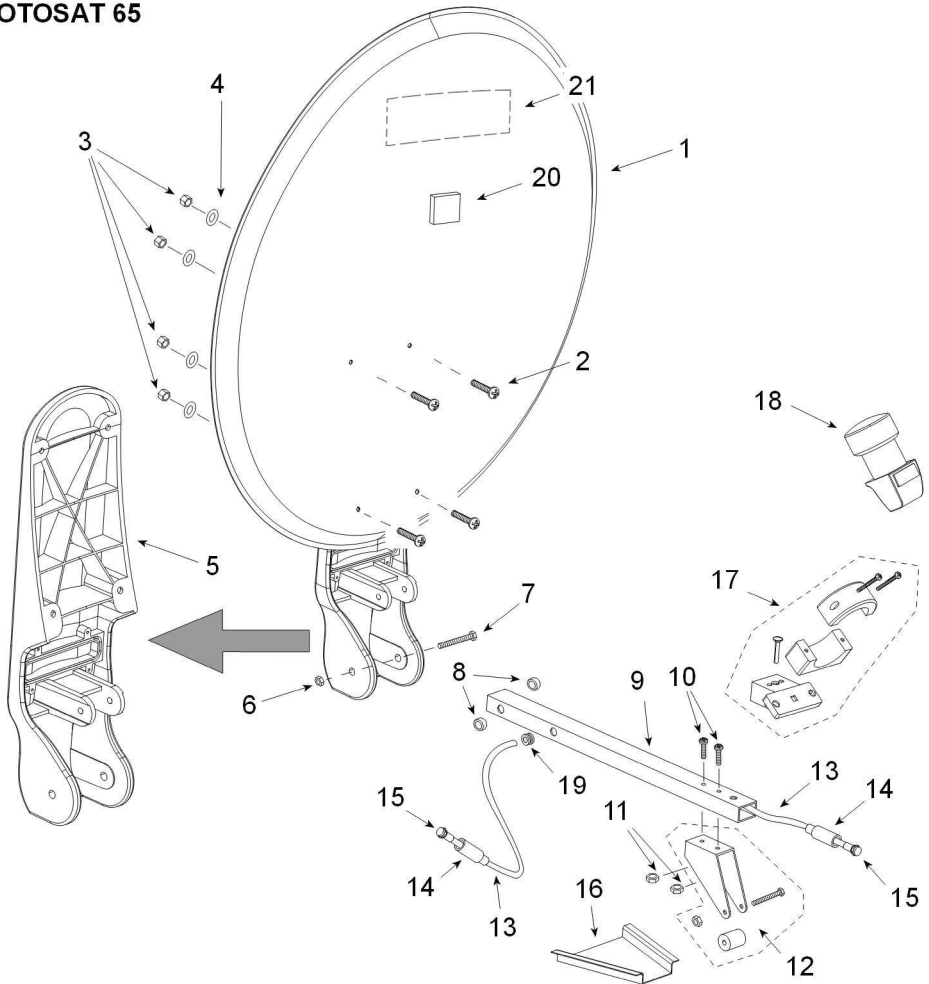

Pos.	Code	Q.ty	Description (24/11/2017)
1	10487	N.1	Parabolic antenna D=63.5x59 cm
2	10425	N.4	Screw M5X10
3	03685	N.4	Self-locking nut M5
4	15616	N.4	Flat washer D 5
5	10757	N.1	Support dish arm
6	03684	N.1	Self-locking nut M6
7	10979	N.1	Screw 6x55
8	06076	N.2	Nylon bush
9	10561	N.1	LNB support tube / 65 (BLUSAT)
10	09013	N.2	Screw M5x25
11	09015	N.2	Nut M5
12	12878	N.1	Roll support bracket
13	13159	MT.7	Coaxial Cable
14	03459	N.2	Connector protecting rubber
15	15077	N.2	F50 F connector
16	06132	N.1	Arm rest
17	08628	N.1	LNB Plastic Kombi-type support
18	16992	N.1	LNB Stark ST1
19	05293	N.1	Hole grommet
20	05735	N.1	Transparent rubber
21	12838	N.1	Dish sticker

MOTOSAT 85

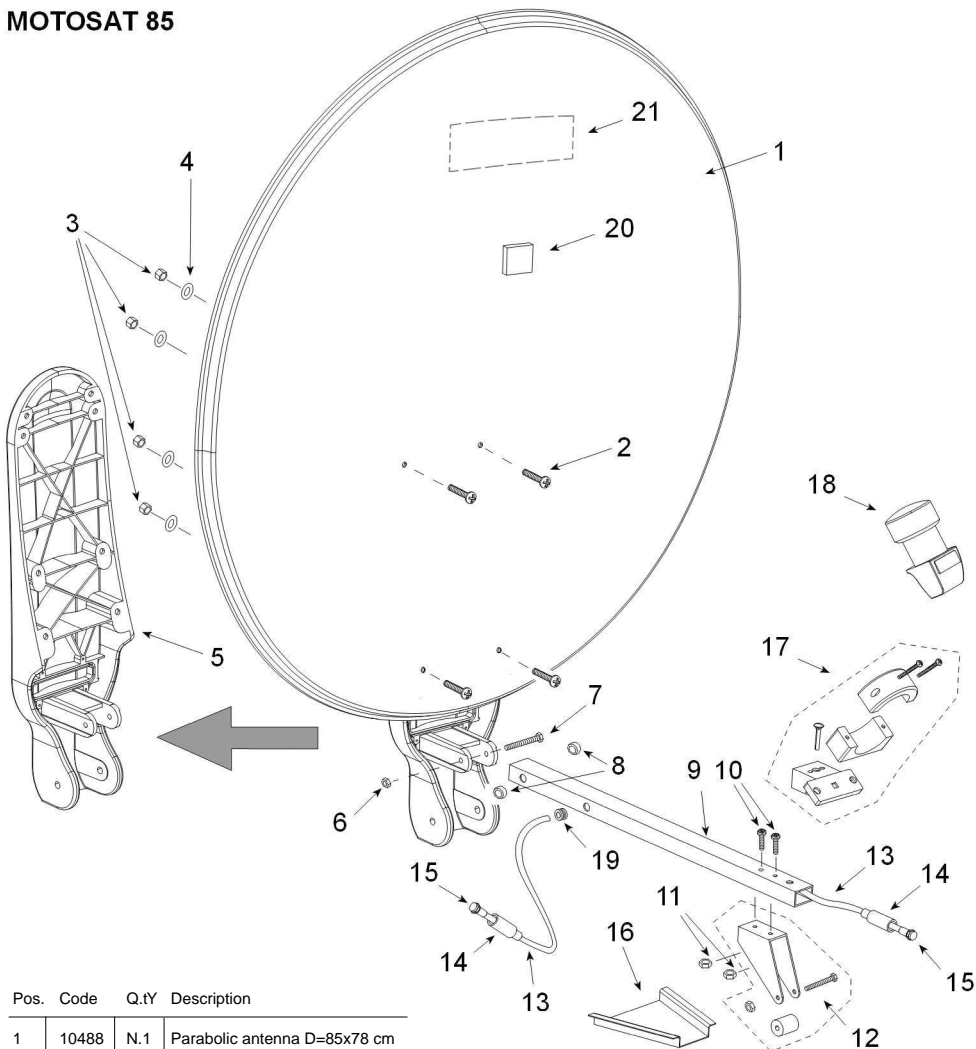

Pos.	Code	Q.tY	Description
1	10488	N.1	Parabolic antenna D=85x78 cm
2	10910	N.4	Screw M6X12
3	03684	N.4	Self-locking nut M6
4	15617	N.4	Flat washer D 6
5	10998	N.1	support dish arm
6	03684	N.1	Self-locking nut M6
7	10979	N.1	Screw 6x55
8	06076	N.2	Nylon bush
9	10564	N.1	LNB support tube / 85 (BLUSAT)
10	09013	N.2	Screw M5x25
11	09015	N.2	Nut M5
12	12878	N.1	Roll support bracket
13	13159	MT.7	Coaxial Cable
14	03459	N.2	Connector protecting rubber
15	15077	N.2	F50 F connector
16	06132	N.1	Arm rest
17	08628	N.1	LNB Plastic Kombi-type support
18	16992	N.1	LNB Stark ST1
19	05293	N.1	Hole grommet
20	05735	N.1	Transparent rubber
21	12838	N.1	Dish sticker

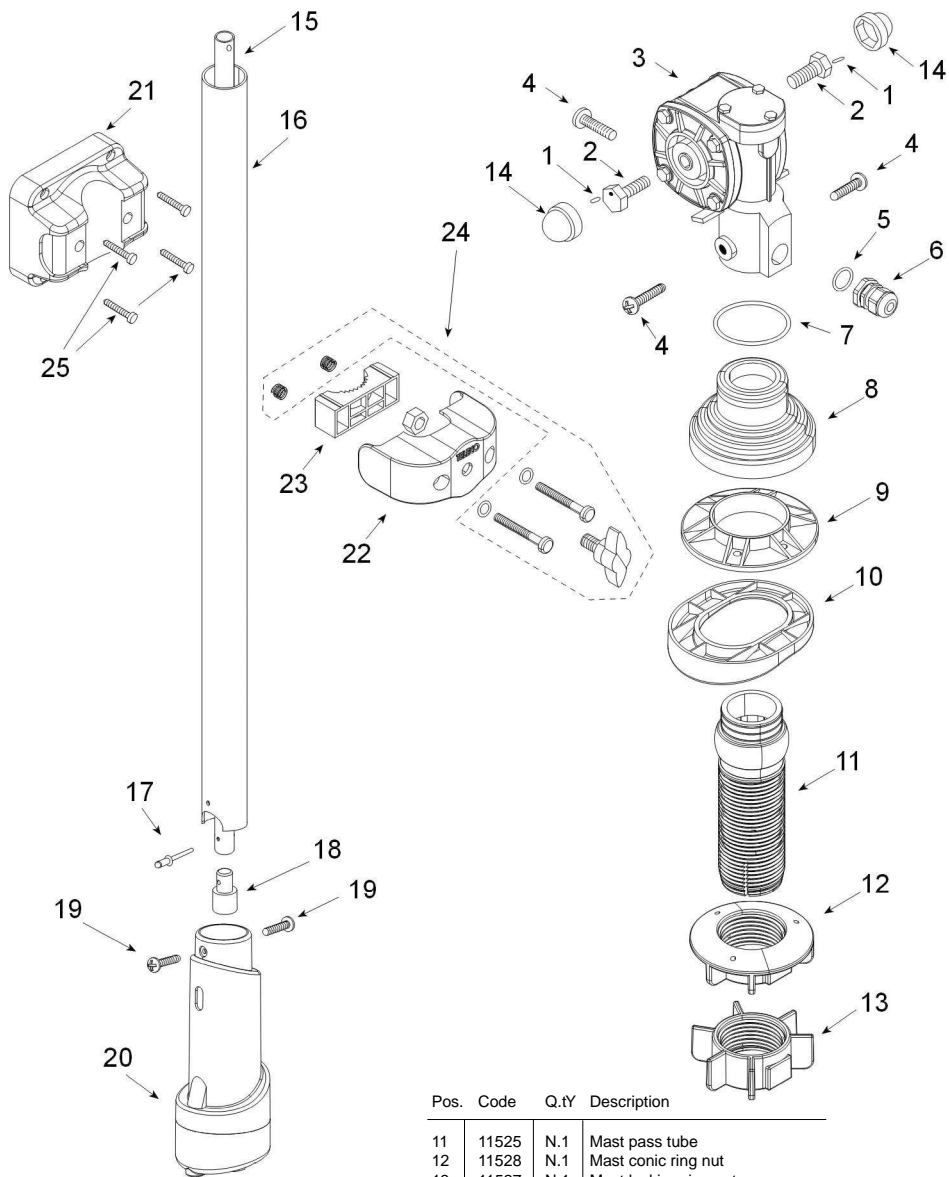

Pos.	Code	Q.ty	Description
1	05799	N.2	Arm locking dowel
2	07446	N.2	Arm locking screw
3	11200	N.1	Reduction gear
4	11805	N.3	Trilobed screws 5X12
5	03244	N.1	OR Gasket PG 9
6	07956	N.1	Fairlead skintop PG9
7	12030	N.1	Rubber gasket spring
8	11524	N.1	Mast gasket
9	11523	N.1	Mast inclinable flange
10	11526	N.1	Mast conic inclination adapter

Pos.	Code	Q.ty	Description
11	11525	N.1	Mast pass tube
12	11528	N.1	Mast conic ring nut
13	11527	N.1	Mast locking ring nut
14	14996	N.2	Nut cover M14 black polyethylene
15	10983	N.1	Adjustment shaft 12x0.95x498
16	12972	N.1	Supporting tube L= 519mm
17	03605	N.1	Tear rivet
18	12962	N.1	Zamak hex female insert motosat
19	02075	N.2	Self-tapping screw 4x10
20	13014	N.1	Control knob complete with gearmotor + electronics
21	18175	N.1	Fixing bracket bottom
22	18176	N.1	Fixing bracket cover
23	18179	N.1	Fixing bracket clamp
24	18178	N.1	Fixing bracket screws
25	18180	N.1	4 Self-tapping screws 3.5x30

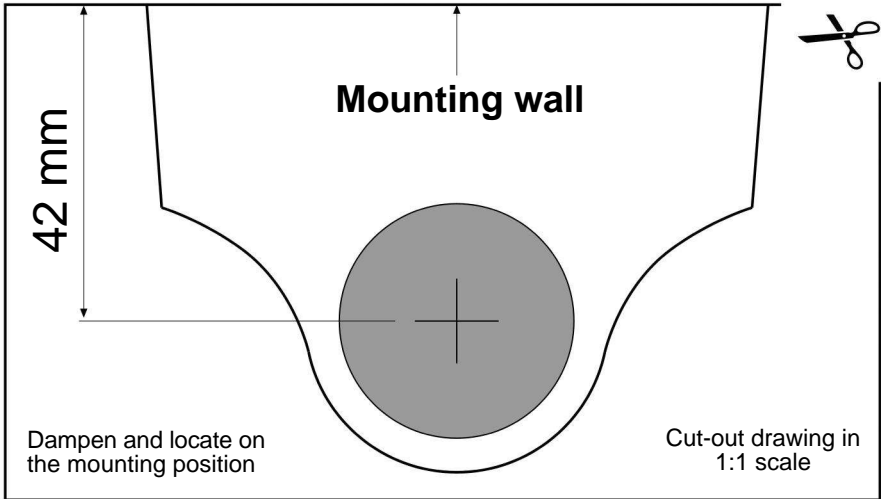

CONFORMITY CERTIFICATE

The manufacturer Teleco Spa
Via Majorana nr. 49, 48022 Lugo (RA)

Declares under its own responsibility that the following products:

MOTOSAT 65 - MOTOSAT 85

which are the subject of this certificate, conform to the following norms:

- EN 60065: 2002 - EN 55013: 2001 + A1: 2003
- EN 61000 – 3 - 2: 2000 + A2: 2500
- EN 61000 – 3 – 3: 1995 + A1: 2001 + A2: 2005
- EN 55020: 2002 + A2: 2005

according to the terms of the European directive 2006/95/EC
Low Voltage (modified by 93/68/CEE) and
2004/108/CEE of Electromagnetic Compatibility
(modified by 92/31/CEE e 93/68/CEE)
of the European Parliament.

Lugo 22 / 02 / 2018

THE PRESIDENT

Ing. Raul Fabbri



Recycling: with a view to reducing disposal of waste electrical and electronic equipment as much as possible, do not throw out this end of life appliance together with other unsorted municipal waste, but make use of a recycling centre.

CE



Group
TELECO



 **TELECO** SPA
ITALY

Via E. Majorana 49
48022 LUGO (RA)
Tel. + 39 0545 25037
Fax. + 39 0545 32064
mail: info@telecogroup.com
www.telecogroup.com
Assistenza 899 899 856

 **TELECO** GmbH
DEUTSCHLAND

82041 Deisenhofen
Tel. 08031 98939
Fax 08031 98949
telecogmbh@telecogroup.com
www.telecogroup.com

 **TELECO** SCS
FRANCE

3, Impasse des Iles
ZA La Maladière
07300 St Jean de Muzols
mail: contact@telecogroup.fr
www.telecogroup.fr

 **Telair** SRL
ITALY

Via E. Majorana 49
48022 LUGO (RA)
Tel. + 39 0545 25037
Fax. + 39 0545 32064
mail: telair@telecogroup.com
www.telecogroup.com

IN EUROPE:

GREAT BRITAIN - SCAN TERIEUR LTD
30, The Metro Centre, Tolpits Lane - Watford,
Herts - England - WD18 9XG
Tel. 01923 800353 - Fax 01923 220358
e-mail: info@scan-terieur.com
www.scan-terieur.com

THE NETHERLANDS/BELGIUM/LUXEMBOURG/DENMARK/SWEDEN
KARMAN TRADING
Tel. +31 (0) 341 722450 - Fax +31 (0) 341 722451
e-mail: info@karmantrading.eu
www.karmantrading.eu

FRANCE - TELECO SAS
3, impasse des Iles - ZA La Maladière
07300 St Jean de Muzols - France
Tél. 04 75 08 49 17 - Fax 09 70 32 83 00
contact@telecogroup.fr
www.telecogroup.fr

SERVICE COMMERCIAL :
Jean-Philippe Bleyes
Tél. 02 48 58 03 67 Fax 02 48 58 35 85
teleco.telair@bleysetd.com
Service Technique :
Tél. 06 83 31 44 05 ou 04 75 08 28 25
www.techmobilefrance.com

ESPAÑA - ADD SICMAP S.L.
EVA Caravan - Via Sergia 92 - Pol. Ind. Pla d'en Boet II
08302 MATARO (Barcelona)
Tel. 93 790 35 26 - Fax. 93 796 21 17
info@addsicmap.com
Servicio técnico: Fills de Rocha i Lopez, S.L- C/Goya,4
08903 L'Hospitalet de Llogrebat - Barcelona - España
Tel. 933 333 753 - Fax 933 337 236
fillsrocha@fillsrocha.com

ÖSTERREICH - TELECO GmbH
82041 Deisenhofen - Deutschland
Tel. 0049 8031 98939 - Fax. 0049 8031 98949
telecogmbh@telecogroup.com
www.telecogroup.com
SERVICE 0900 94 90 70

DEUTSCHLAND - TELECO GmbH
82041 Deisenhofen - Deutschland
Tel. 08031 98939 - Fax 08031 98949
telecogmbh@telecogroup.com
www.telecogroup.com
Vertretung:
ZIMMER
Ziegenhainer Str. 7 - 34626 Neukirchen
Tel. 06694-9108000 - Fax 06694-9108008
info@zimmer-mobiltechnik.de
www.zimmer-mobiltechnik.de
SERVICE 08921129997

Foto e disegni non contrattuali - Les photos et les dessins ne sont donnés qu'à titre
indicatif - We reserve the right to make technical changes without prior notice -
Fotos und Zeichnungen nicht vertraglich - Foto's en tekeningen niet contractueel -
Fotos y planos no indicados en contrato

 **BOSCH**
Service
Kundendienst beim
ausgewählten
Bosch Service!



www.facebook.com/pages/
Telecogroup/213241202111442